



Model IO-30/8 Octa-Ring Bolt-Together Campfire Ring

**SPECIFICATION
BULLETIN**
#SPC-FR-065
REV. 09-17



Model IO-30/8 Octa-Ring Campfire Ring
as a stand-alone firering.



Model IO-30/8 Octa-Ring Campfire Ring as a firering insert
used with landscaping stone (sold separately).

SPECIFICATIONS:

- **Model IO-30/8 Octa-Ring Campfire Ring** is a bolt-together campfire ring designed to stand alone as a firering or to fit a variety of fire pits as a steel insert. Ring can be disassembled and taken on camping trips.
- As a stand-alone firering, the Octa-Ring provides a solid 8" (nom.) tall fire barrier.
- The ring can be used as an insert in fire pits with a 30" to 35" inside diameter.
- The 3-7/8" flange at the top of the ring supports the ring when used as an insert or serves as a convenient work surface.
- The ring is constructed of eight identical die-formed 12 ga. panels with a 7-7/8" side height and a 3-7/8" formed (not welded) top outward flange.
- The panels are secured together by galvanized steel fasteners supplied with the ring.
- Overall dimensions are 37-11/16" x 7-7/8".
- Entire unit is finished in high temperature, heat resistant, nontoxic black enamel paint.
- **Assembly Required.**
- **Ships in one box.**
Weight: 37 lbs.
Dimensions: 9-3/4"W x 15-1/2"L x 7-1/4"H.

FEATURES

- Use as a stand-alone campfire ring
- Use as an insert for patio fire pits made of landscaping stone.
- Bolt-together assembly can be disassembled to take on camping trips
- Creates a nearly eight inch tall solid fire barrier
- Perfect fit for Model DIG-U2 Drop-in Cooking Grate
- Quality construction throughout

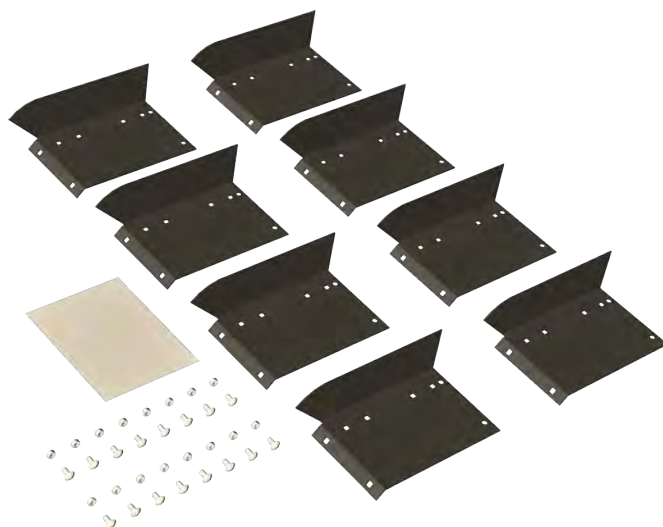

Content of the box

RJThomas Mfg. Co., Inc.

PO Box 946 • Cherokee, IA 51012-0946 • PH: 712-225-5115 • 800-762-5002 • FAX: 712-225-5796

E-Mail: customerservice@rjthomas.com

© 2015 RJThomas Mfg. Co., Inc.

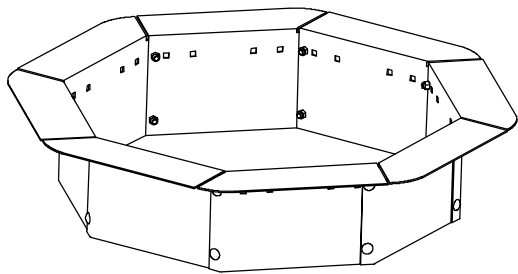

USE IO-30/8 AS A
STAND-ALONE FIRERING

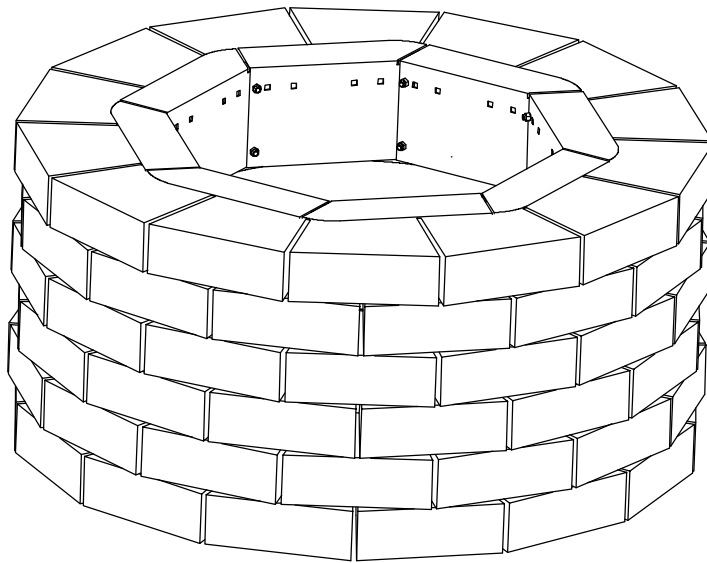

USE IO-30/8 AS AN INSERT
FOR LANDSCAPING BLOCK
FIREPIT (BLOCKS NOT INCLUDED)

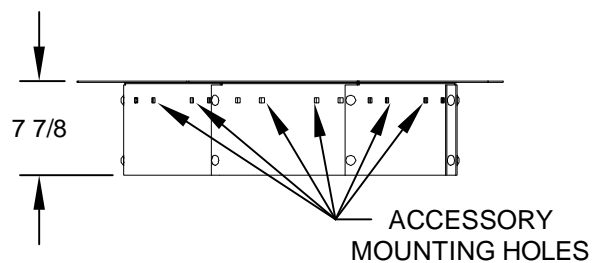
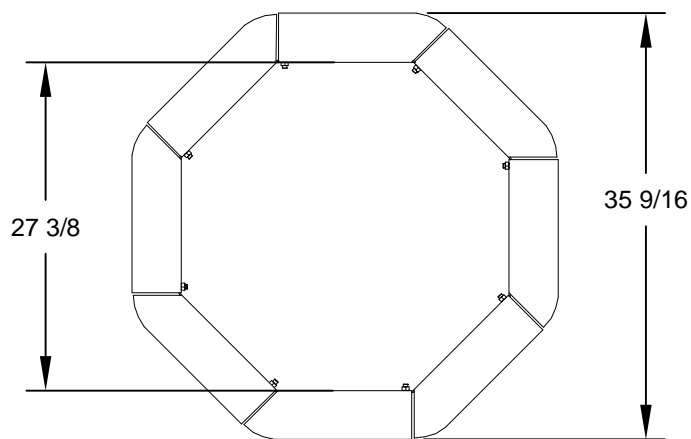
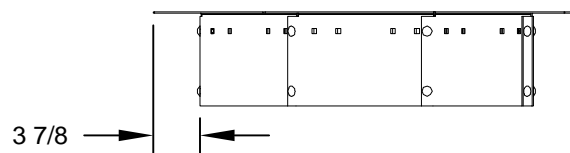
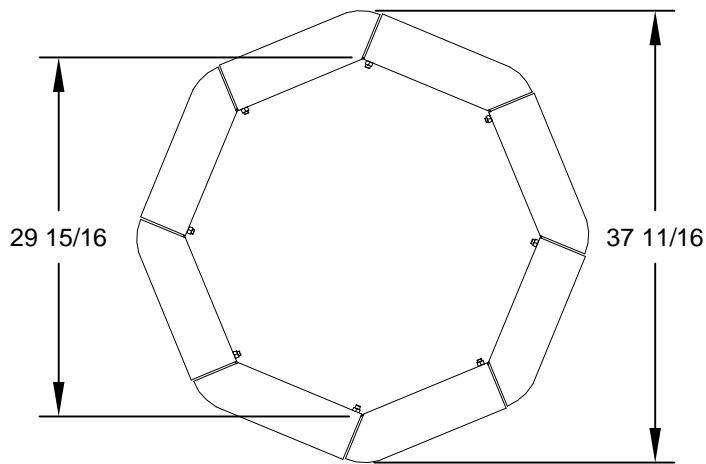

ALL DIMENSIONS IN INCHES

RJThomas
Mfg. Co., Inc.
P.O. Box 946
Cherokee, IA 51012

TITLE MODEL IO-30/8 OCTA-RING BOLT TOGETHER CAMPFIRE
RING/INSERT

DRAWN BY WWM

DATE 1-2-14

DWG. NO. AI-IO-30/8



IX Series Firering Insert for Landscaping Stones

**SPECIFICATION
BULLETIN**
#SPC-FR-064
REV. 12-14



*Model IX-31 Firering Insert for landscaping stones.
Shown with optional Model I-A bolt-on cooking grate kit.*

FEATURES

- **27", 30", or 31" ID 10 ga. steel ring protects landscaping stones from extreme heat**
- **Raises fire to a comfortable working level**
- **Use alone as a fireplace or add optional grates for cookouts**

AVAILABLE OPTIONS

- **1 or 2 bolt-on cooking grates**
- **Fire Screens**
- **Flat steel cover**

SPECIFICATIONS:

- This **IX Series** steel firering insert is designed to fit inside a circular structure of landscaping stones to create a raised fire level for backyard locations. The insert creates a heat and fire barrier to protect the stones. (Note: stones should not be exposed to extreme heat without a steel liner.)
- The **IX Series Round Insert** is an 8" tall ring formed from 10 ga. steel supported by a 1-1/2" outside flange at the top of the ring resting on the top of the stones. Coarse aggregate fill (not included) provides a raised level for the fire and protects ground surfaces from heat.
- **Model IX-27** has a 27" ID.
- **Model IX-30** has a 30" ID.
- **Model IX-31** has a 31" ID.
- Entire insert unit is finished in high temperature, heat resistant, nontoxic black enamel paint.
- Overall height of the stone is at the discretion of owner (typically 20" to 24"). Stones should be assembled according manufacturer specifications.
- **Optional:** A variety of cooking grate configurations are available as a bolt-on option. Grates are constructed of 1/2" dia. A-36 steel bar spaced at 1-1/8" intervals with a 1/2" dia. A-36 steel bar perimeter frame. Grates are secured to the insert with a bolted-on 1/2" dia. A-36 steel retaining bar that allows the grate to be flipped upward for fire building or pulled back for an unobstructed view of the fire. Kit includes a 1/4" dia. steel bar hook for repositioning hot grates. One grate, or two opposing grates can be added to the insert. Order grate kits as a separate item.
 - **Model I-A bolt-on grate kit**
(1) 12" x 21" 252 sq. in. cooking grate and brackets
 - **Model I-B bolt-on grate kit**
(1) 12" x 33" 396 sq. in. cooking grate and brackets
- **Optional: Model IAFS-30 Fire Screen** is a heavy duty 37-3/4" dia. x 13" high expanded steel ring with an expanded steel flat top surface supported by formed steel base and top rings. Screen is removable. Screen is intended to contain ash when fireplace is in use. Fits all insert and option combinations. Weighs 60 lbs.
- **Optional: Model AD6071 Easy Access Fire Screen** dome covers entire insert, or lift one side of screen for easy access to fire or cooking grates. Fits all insert and option combinations. Weighs 17 lbs. Screen is intended to contain ash when fireplace is in use.
- **Optional: Model IAC-30 Cover** is an 18 ga. pregalvanized flat steel cover with two handles intended to cover the firepit when not in use.

RJThomas Mfg. Co., Inc.

PO Box 946 • Cherokee, IA 51012-0946 • PH: 712-225-5115 • 800-762-5002 • FAX: 712-225-5796

E-Mail: customerservice@rjthomas.com

© 2015 RJThomas Mfg. Co., Inc.

**OPTIONAL BOLT-ON GRATE
CONFIGURATIONS FOR IX SERIES INSERT**

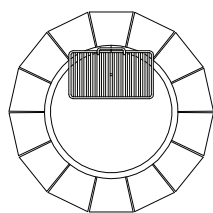

**(1) MODEL I-A GRATE KIT
SINGLE 12" X 21" 252 SQ. IN.
COOKING GRATE**

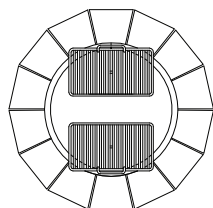

**(2) MODEL I-A GRATE KITS
TWO 12" X 21" 252 SQ. IN.
COOKING GRATES
504 SQ. IN. TOTAL**

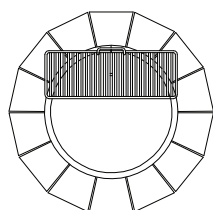

**(1) MODEL I-B GRATE KIT
SINGLE 12" X 33" 396 SQ. IN.
COOKING GRATES**

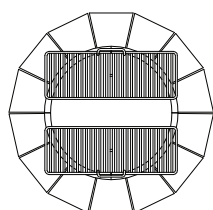

**(2) MODEL I-B GRATE KITS
TWO 12" X 33" 396 SQ. IN.
COOKING GRATES
792 SQ. IN. TOTAL**

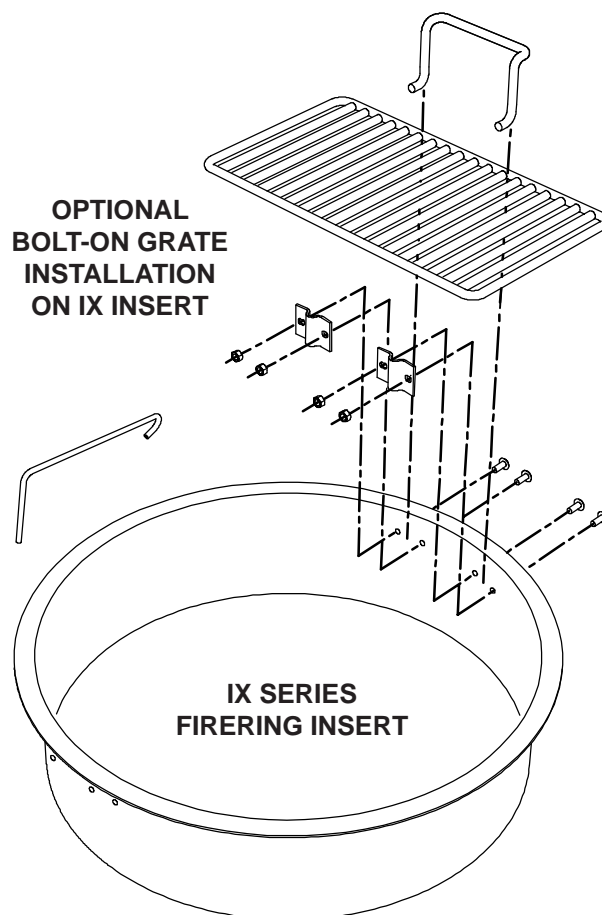

Installation Guide

Establish a suitable subbase by removing any organic material and replace with compactible granular aggregate. (Concrete pavers are illustrated but not required.) Use the insert as a guide to lay modular stones spaced equally in a suitable circle leaving a one inch air gap between the insert and stones. Arrange stones to obtain the desired height of the firepit. Place the insert and fill the pit with coarse granular fill to the bottom of the steel insert.

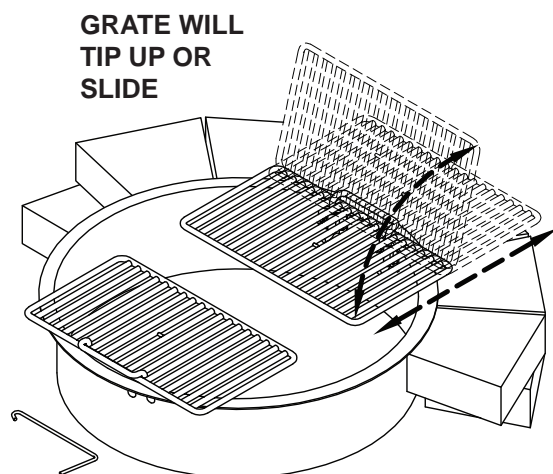

**GRATE WILL
TIP UP OR
SLIDE**

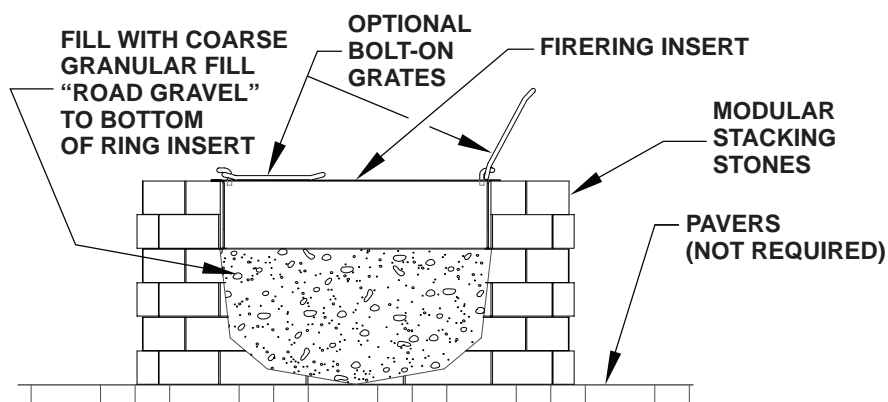

**FILL WITH COARSE
GRANULAR FILL
"ROAD GRAVEL"
TO BOTTOM
OF RING INSERT**

**OPTIONAL
BOLT-ON
GRATES**

FIRERING INSERT

**MODULAR
STACKING
STONES**

**PAVERS
(NOT REQUIRED)**

RJThomas Mfg. Co., Inc.

PO Box 946 • Cherokee, IA 51012-0946 • PH: 712-225-5115 • 800-762-5002 • FAX: 712-225-5796

E-Mail: customerservice@rjthomas.com

© 2015 RJThomas Mfg. Co., Inc.



IQ Series Square Bolt Together Firepit Insert for Landscaping Stones

**SPECIFICATION
BULLETIN**
#SPC-FR-058
REV. 02-18



IQ Series Firepit Insert for landscaping stones.



Model IQ Square Firepit Insert shown with optional **Cooking Grate** in a flipped up position for easy fire building.



Model IQ Square Firepit Insert shown with optional **Cooking Grate** in a slid back position to give a more "open fire" experience.



SPECIFICATIONS:

- **IQ Series** steel firepit insert is designed to fit inside a square structure of landscaping stones for backyard locations. The insert creates a heat and fire barrier to protect the stones. (Note: stones should not be exposed to extreme heat without a steel liner.)
- The **IQ Series Insert** is formed from four 12 ga. steel side panels supported by a 2"-3" outside flange at the top of the panels resting on the top of the stones. Panels bolt together at the corners.
- Insert ships unassembled for reduced packaging. Assembly required. Landscaping stones not included.
- **IQ-23 Insert** is 22-3/4" square inside dimension.
- **IQ-27 Insert** is 27-3/16" square inside dimension.
- **IQ-32 Insert** is 31-11/16" square inside dimension.
- Entire insert unit is finished in high temperature, heat resistant, nontoxic black enamel paint.
- Overall height of the stone is at the discretion of owner. The top of the stones provide a convenient work surface. Stones should be assembled allowing an approximate 1" air gap around the entire insert according to stone manufacturer's specifications. Coarse aggregate fill (not included) inside the stone structure provides a raised level for the fire and protects ground surfaces from heat.
- **Optional:** A bolt-on cooking grate is available for each model of insert. Grates are fully welded, constructed entirely of 1/2" dia. A-36 steel bar spaced at 1-1/8" intervals with a 1/2" dia. steel bar perimeter frame with two 1/2" support bars. Grates are secured to the insert with a bolted-on 1/2" dia. steel retaining bar that allows the grate to be flipped upward for fire building or pulled back for an unobstructed view of the fire. Kit includes a 1/4" dia. steel bar hook for repositioning hot grates. One grate can be added to the insert. Order grate kit as a separate item.
- **Model IQ-A bolt-on grate kit for IQ-23 Insert**
(1) 12" x 21" 252 sq. in. cooking grate and brackets.
- **Model IQ-P bolt-on grate kit for IQ-27 Insert**
(1) 17" x 27-7/8" 474 sq. in. cooking grate and brackets.
- **Model IQ-B bolt-on grate kit for IQ-32 Insert**
(1) 12" x 33" 396 sq. in. cooking grate and brackets.

FEATURES

- **Six sizes to choose from**
- **Steel insert protects landscaping stones from extreme heat**
- **Use alone as a firepit insert or add an optional grate for cookouts**

AVAILABLE OPTIONS

- **23, 27, or 32 inch square models, 8 or 12 inches deep**
- **Bolt-on cooking grate**

RJThomas Mfg. Co., Inc.

PO Box 946 • Cherokee, IA 51012-0946 • PH: 712-225-5115 • 800-762-5002 • FAX: 712-225-5796

E-Mail: customerservice@rjthomas.com

© 2018 RJThomas Mfg. Co., Inc.

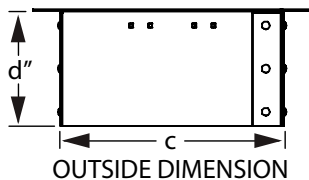
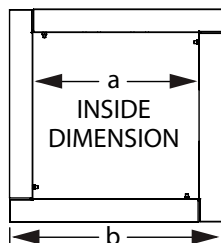

MODEL	DIMENSION			
	a	b	c	d
IQ-23/8	22-3/4"	27-1/8"	23-1/16"	8"
IQ-23/12	22-3/4"	28-7/8"	23-1/16"	12"
IQ-27/8	27-3/16"	33-1/4"	27-7/16"	8"
IQ-27/12	27-3/16"	33-1/4"	27-7/16"	12"
IQ-32/8	31-11/16"	37-3/4"	31-15/16"	8"
IQ-32/12	31-11/16"	37-3/4"	31-15/16"	12"

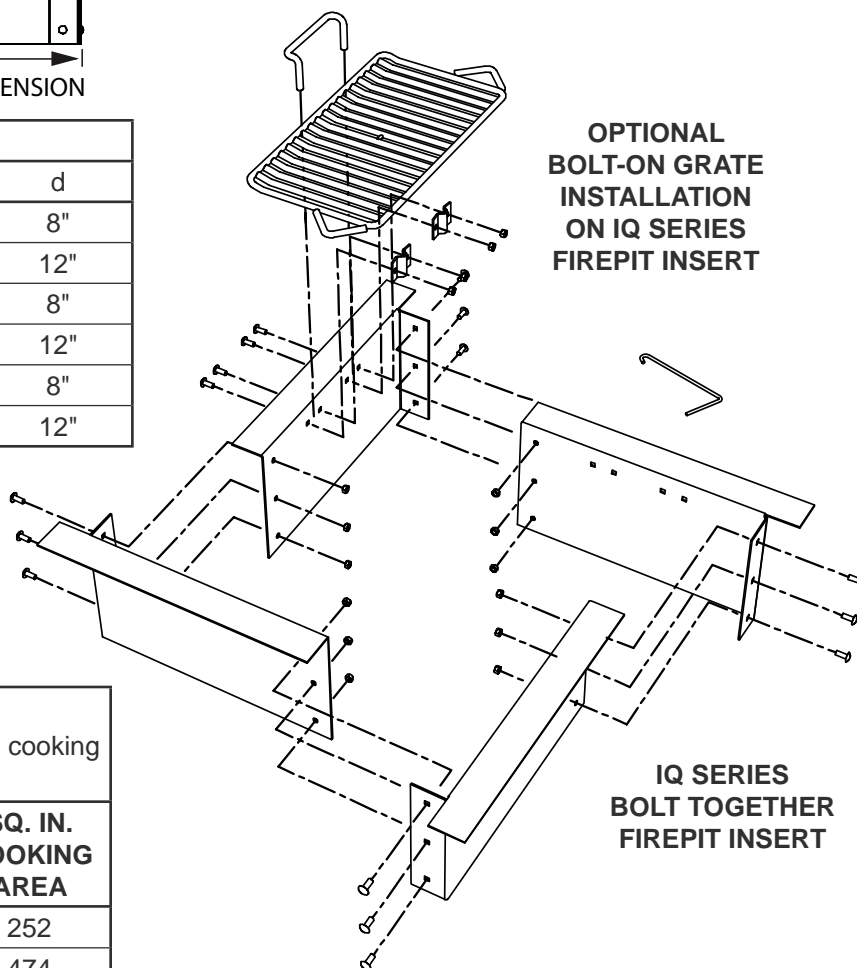

OPTIONAL COOKING GRATE KITS

Use the table below when ordering an optional cooking grate kit. Order grate kit as a separate item.

INSERT MODEL	USE GRATE KIT MODEL	GRATE DIMENSIONS	SQ. IN. COOKING AREA
IQ-23	IQ-A	21-1/8" X 12"	252
IQ-27	IQ-P	27-7/8" X 17"	474
IQ-32	IQ-B	33-1/8" X 12"	396

GRATE WILL TIP UP OR SLIDE

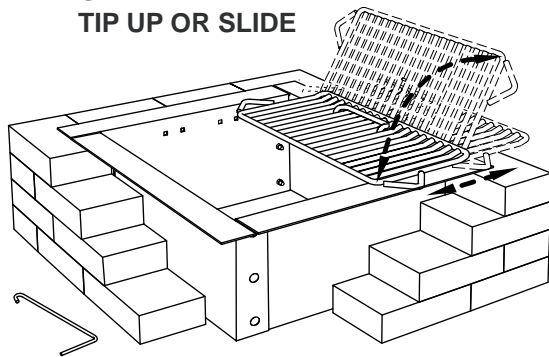

Installation Guide

Following block manufacturer guidelines, use the insert as a guide to lay stones spaced equally in a suitable square to allow an air gap of 1 inch between insert and stone. Place the insert and fill the pit with coarse granular fill to the bottom of the steel insert.

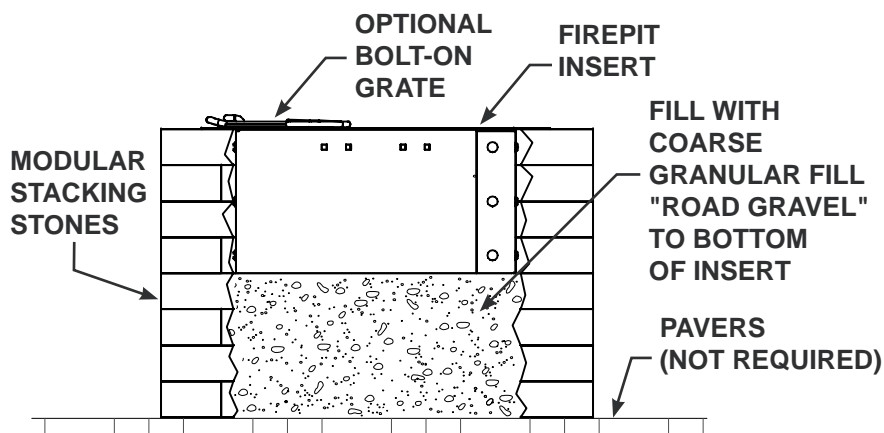

RJThomas Mfg. Co., Inc.

PO Box 946 • Cherokee, IA 51012-0946 • PH: 712-225-5115 • 800-762-5002 • FAX: 712-225-5796

E-Mail: customerservice@rjthomas.com

© 2018 RJThomas Mfg. Co., Inc.



Model IHSS-22/6 SS Fire Pit Insert Kit w/ DIG/S-3 Drop In Cooking Grate

**SPECIFICATION
BULLETIN
#SPC-FR-069
REV. 11-17**

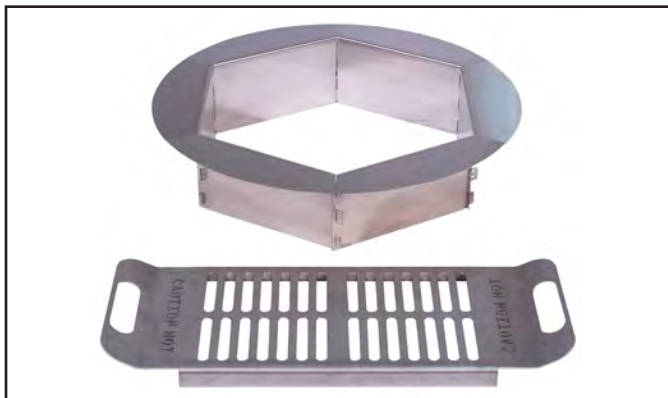

Model IHSS-22/6 Stainless Steel Fire Pit Insert shown with included **Model DIG/S-3 Drop-In Cooking Grate**



Model IHSS-22/6 Stainless Steel Fire Pit Insert shown with included **Model DIG/S-3 Drop-In Cooking Grate** used with landscaping stone (sold separately).

SPECIFICATIONS:

- **Model IHSS-22/6 Stainless Steel Fire Pit Insert** is an 18 ga. stainless steel snap-together fire pit insert designed to fit a variety of fire pits as a steel insert. This kit includes **Model DIG/S-3** stainless steel drop in cooking grate.
- The hexagon-shaped ring can be used as an insert in fire pits with a 22-1/4" to 25-1/2" inside diameter.
- Aggregate fill should meet the bottom edge of this insert for taller fire pits.
- The 3-3/4" flange at the top of the ring supports the ring on landscape blocks and serves as a convenient work surface.
- The ring is constructed of six (6) identical die-formed 18 ga. stainless steel slotted panels which snap together; no fasteners are required.
- Assembled ring has a 5-3/4" side height and a 3-7/8" formed (not welded) top outward flange.
- Overall dimensions are 26" x 5-3/4". Inside diameter is roughly 22".
- Entire unit is stainless steel finish. This product is not painted.
- **Included:** This kit includes **Model DIG/S-3** drop in cooking grate to provide 189 sq inches of cooking area when needed. This removable cooking surface is laser cut from a single piece of 11 ga. stainless steel plate. Handles are cut and formed at each end. Overall dimensions are 26-7/8"L x 10-1/2" wide.
- **Assembly Required.**
- **Both items ship in one box.**
Weight: 17 lbs.
Box Dimensions: 27-1/8"W x 11-1/8"L x 4-1/8"H.

FEATURES

- Use as an insert for backyard fire pits made of landscaping stone
- Snap together assembly; no fasteners are required
- Includes Model DIG/S-3 Drop-in Cooking Grate
- Quality construction throughout

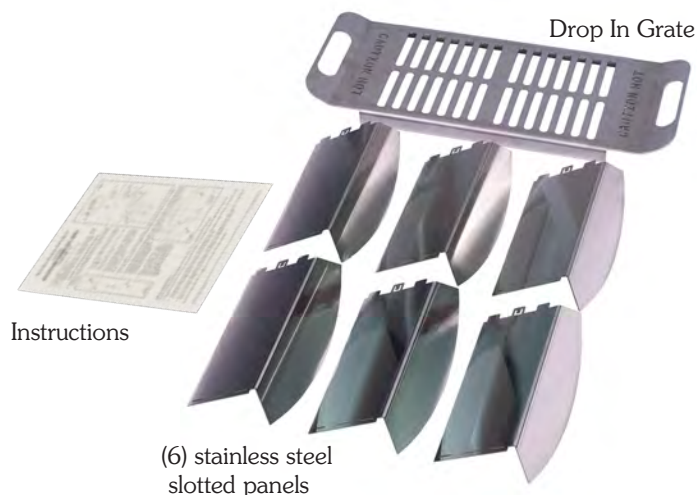

Content of the box

RJThomas Mfg. Co., Inc.

PO Box 946 • Cherokee, IA 51012-0946 • PH: 712-225-5115 • 800-762-5002 • FAX: 712-225-5796

E-Mail: customerservice@rjthomas.com

© 2017 RJThomas Mfg. Co., Inc.

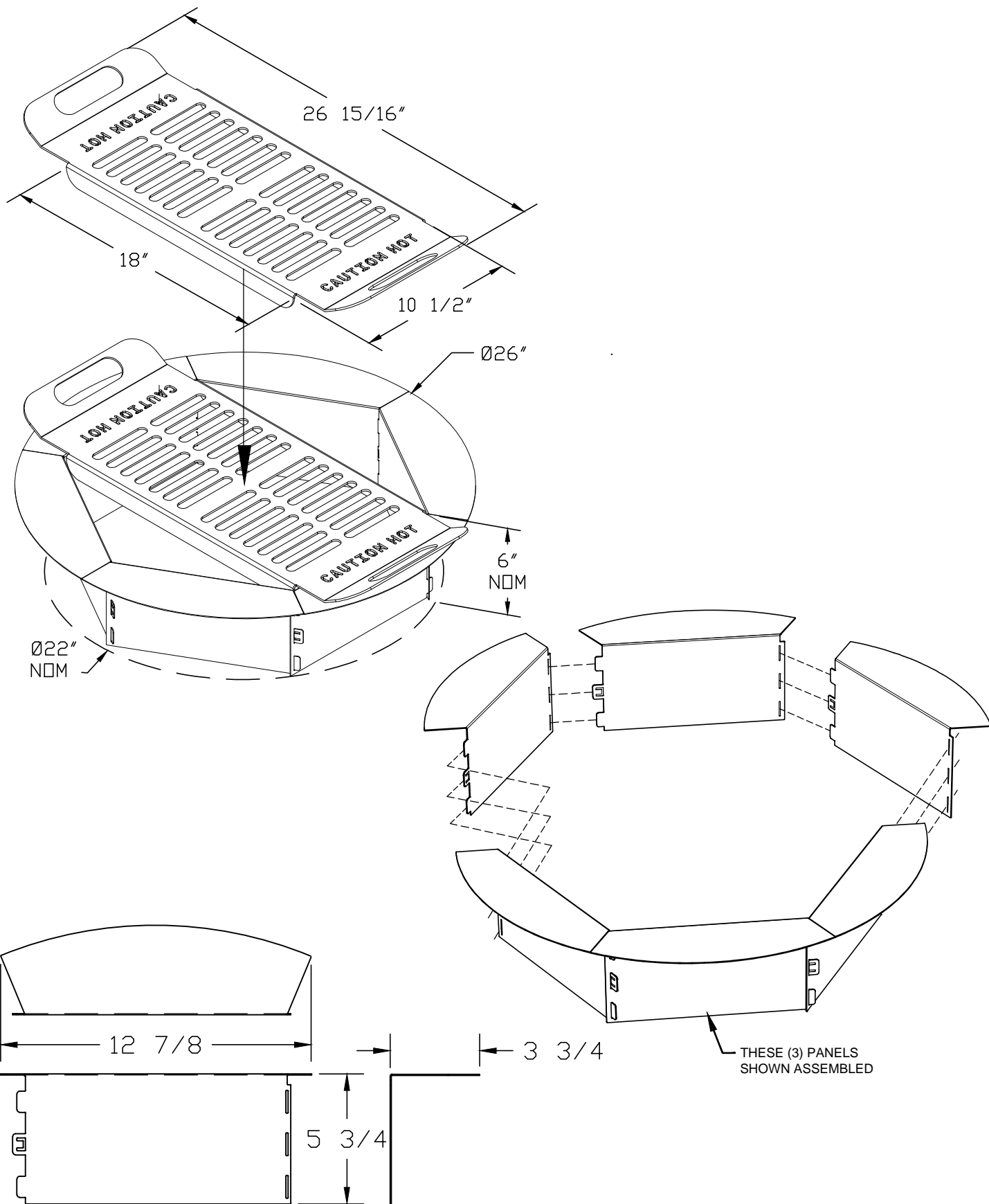

ALL DIMENSIONS IN INCHES

RJThomas
Mfg. Co., Inc.
 P.O. Box 946
 Cherokee, IA 51012

TITLE

MODEL IHSS-22/6 Stainless Steel Fire Pit Insert Kit with
DIG/S-3 Drop In Cooking Grate

DRAWN BY

JGJ

DATE

09-28-17

DWG. NO.

AI-2088



Model IOSS-31/6 Stainless Steel Fire Pit Insert Kit

**SPECIFICATION
BULLETIN**
#SPC-FR-068
REV. 12-18



Model IOSS-31/6 Stainless Steel Fire Pit Insert used with landscaping stone (sold separately).



Model IOSS-31/6 Stainless Steel Fire Pit Insert shown with optional (DIG/S-U4) Drop-In cooking Grate

SPECIFICATIONS:

- **Model IOSS-31/6 Stainless Steel Fire Pit Insert** is an 18 ga. stainless steel snap-together fire pit insert designed to fit a variety of fire pits as a steel insert.
- The octagon-shaped ring can be used as an insert in fire pits with a 31-1/4" to 35-1/2" inside diameter.
- Aggregate fill should meet the bottom edge of this insert for taller fire pits.
- The 3-7/8" flange at the top of the ring supports the ring on landscape blocks and serves as a convenient work surface.
- The ring is constructed of eight (8) identical die-formed 18 ga. stainless steel slotted panels which snap together; no fasteners are required.
- Assembled ring has a 5-3/4" side height and a 3-7/8" formed (not welded) top outward flange.
- Overall dimensions are 36" x 5-3/4". Inside diameter is roughly 31".
- Entire unit is stainless steel finish. This product is not painted.
- **Assembly Required.**
- **Ships in one box.**
Weight: 12 lbs.
Box Dimensions: 13-3/4"W x 6-1/4"L x 4-3/8"H.
- **Optional:** Model DIG/S-U4 Drop In Cooking Grate can provide a removable stainless steel cooking surface when needed.

FEATURES

- Use as an insert for patio fire pits made of landscaping stone
- Snap together assembly; no fasteners are required
- Perfect fit for Model DIG/S-U2 Drop-in Cooking Grate
- Quality construction throughout

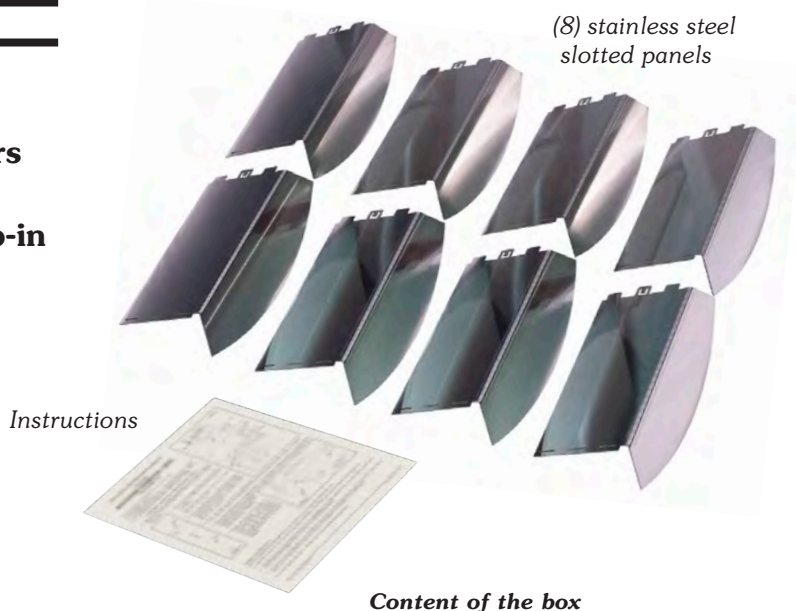

RJThomas Mfg. Co., Inc.

PO Box 946 • Cherokee, IA 51012-0946 • PH: 712-225-5115 • 800-762-5002 • FAX: 712-225-5796

E-Mail: customerservice@rjthomas.com

© 2018 RJThomas Mfg. Co., Inc.

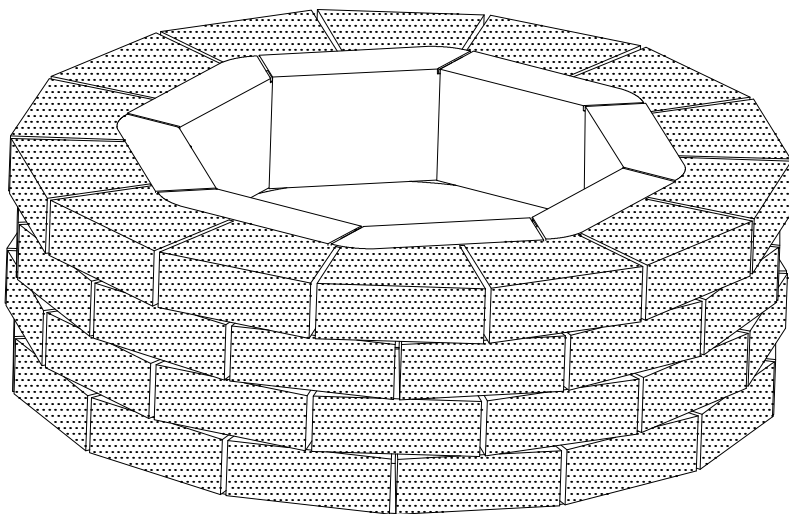

USE IOSS-31/6 AS AN INSERT
FOR LANDSCAPING BLOCK
FIREPIT (BLOCKS NOT
INCLUDED)

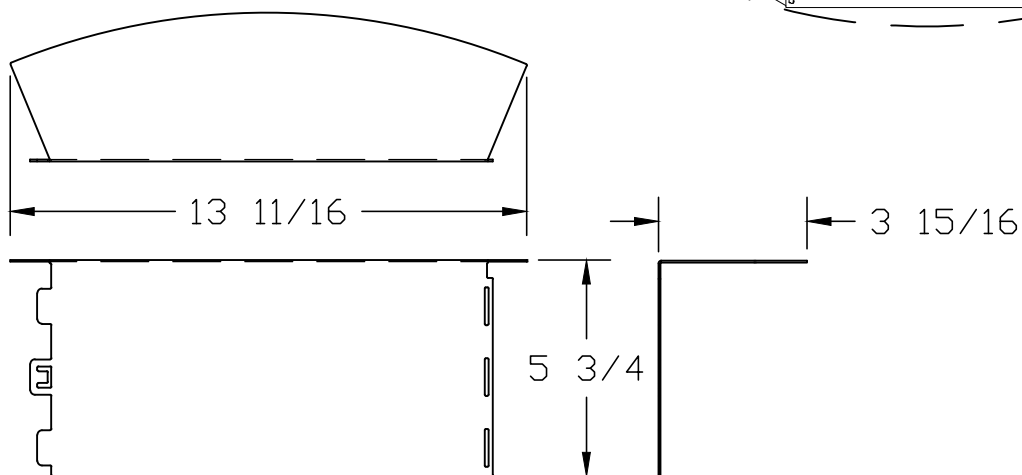
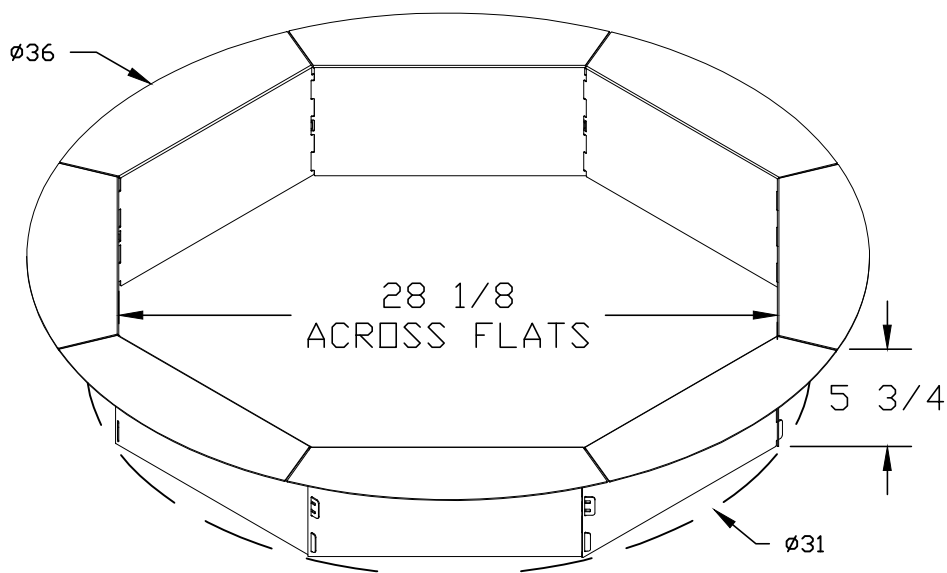

ALL DIMENSIONS IN INCHES

RJThomas
Mfg. Co., Inc.
P.O. Box 946
Cherokee, IA 51012

TITLE

MODEL IOSS-31/6 Octagon Stainless Steel Fire Pit Insert

DRAWN BY

JGJ

DATE

09-28-17

DWG. NO.

AI-2087